



Turkey Leg 5K

YMCA, Willmar, MN



USATF Certificate: MN 10026RR

Certificate Effective From 07/09/2010 to 12/31/2020

Measurement by Tom Reagan - June 29th 2010

Map by Mark Kuhn/UpTempo Race Management
Nov. 16th 2015 - www.uptemporacemanagement.com

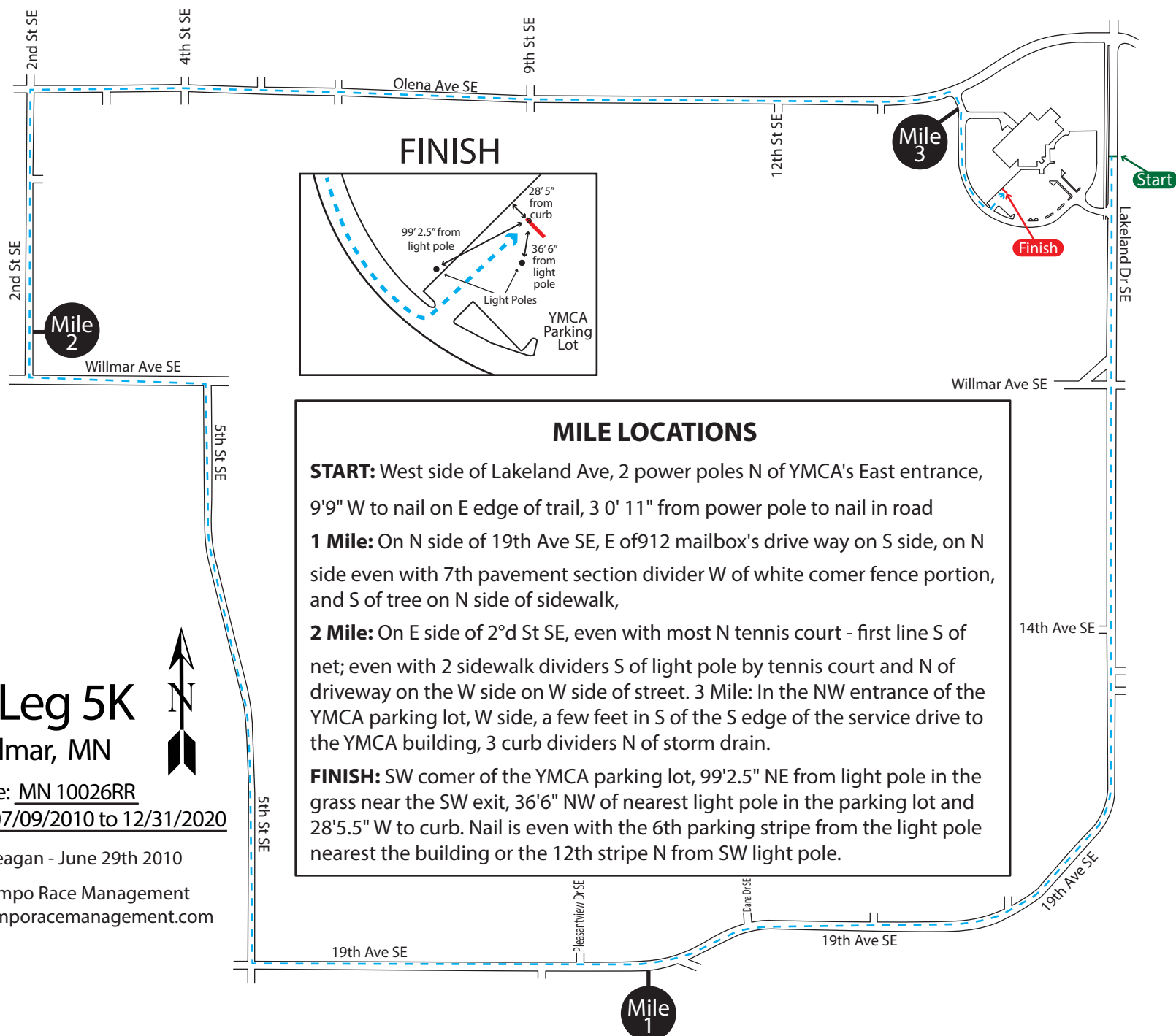
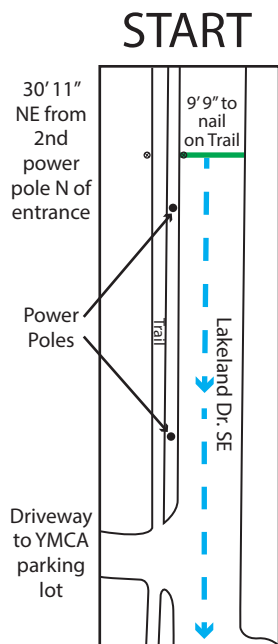

MILE LOCATIONS

START: West side of Lakeland Ave, 2 power poles N of YMCA's East entrance, 9'9" W to nail on E edge of trail, 30' 11" from power pole to nail in road

1 Mile: On N side of 19th Ave SE, E of 912 mailbox's drive way on S side, on N side even with 7th pavement section divider W of white corner fence portion, and S of tree on N side of sidewalk,

2 Mile: On E side of 2nd St SE, even with most N tennis court - first line S of net; even with 2 sidewalk dividers S of light pole by tennis court and N of driveway on the W side on W side of street.

3 Mile: In the NW entrance of the YMCA parking lot, W side, a few feet in S of the S edge of the service drive to the YMCA building, 3 curb dividers N of storm drain.

FINISH: SW corner of the YMCA parking lot, 99'2.5" NE from light pole in the grass near the SW exit, 36'6" NW of nearest light pole in the parking lot and 28'5.5" W to curb. Nail is even with the 6th parking stripe from the light pole nearest the building or the 12th stripe N from SW light pole.