



# USATF Certificate

NJ22033JLW

Effective: 08/15/2022

Through: 12/31/2032

# DUKE ISLAND PARK 5K-2022



Somerset County  
Park Commission

Bridgewater Township  
Somerset County, New Jersey



Date & Time: Tue, Aug 09, 2022, 10:40:17 EDT  
Position: +040.551526° / -074.667173° (+5.0m)  
Altitude: 17m (+4.0m)  
Datum: WGS-84  
Azimuth/Bearing: 349° N11W 6204mils True (+12°)  
Elevation Angle: -04.5°  
Horizon Angle: -00.1°  
Zoom: 1.0X



## START/FINISH DETAIL

**Course Detail-** Start running east on Park Dr. Stay south of the grass islands in the roadway and continue E to join the bike path just SW of the Duck Pond. Follow the path clockwise and stay L to follow the path along the Raritan River after crossing the bridge. R at the closed bridge to follow the detour on the crushed stone, then L to cross the bridge and left again to follow remainder of the detour. R to rejoin bike path along the Raritan River then the next R to follow the loop counterclockwise. Retrace the first portion of the first course in reverse order, but stay L at the bridge near the E side of the course to follow magenta arrows to finish.

**START/FINISH-** The Start and Finish are located at a single point on Park Drive, just west of the Visitor Center. 3'10" E of the eastern edge of the crosswalk, 24'6" W of Light Pole #6890. Marked with PK nail on the S side of the street. **Mile 1-** N 40.549926 W 74.670344 On the bike path just past (W of) the barbecue grill that is just E of the Roberta Fisher bench on the S side of the path. Between the Roberta Fisher bench and Rocco Carra bench. Marked with PK nail. **Mile 2-** N 40.548299 W 74.676338 Even with the large tree bordering the N side of the path before (W of the) the white fishing line recycling bin. **Mile 3-** On Park Dr., SW of the circle, just W of the island dividing the two lanes. Even with the fence post on the E side of the small opening in the fence to the field on the S side of the road. Please see detail photo.

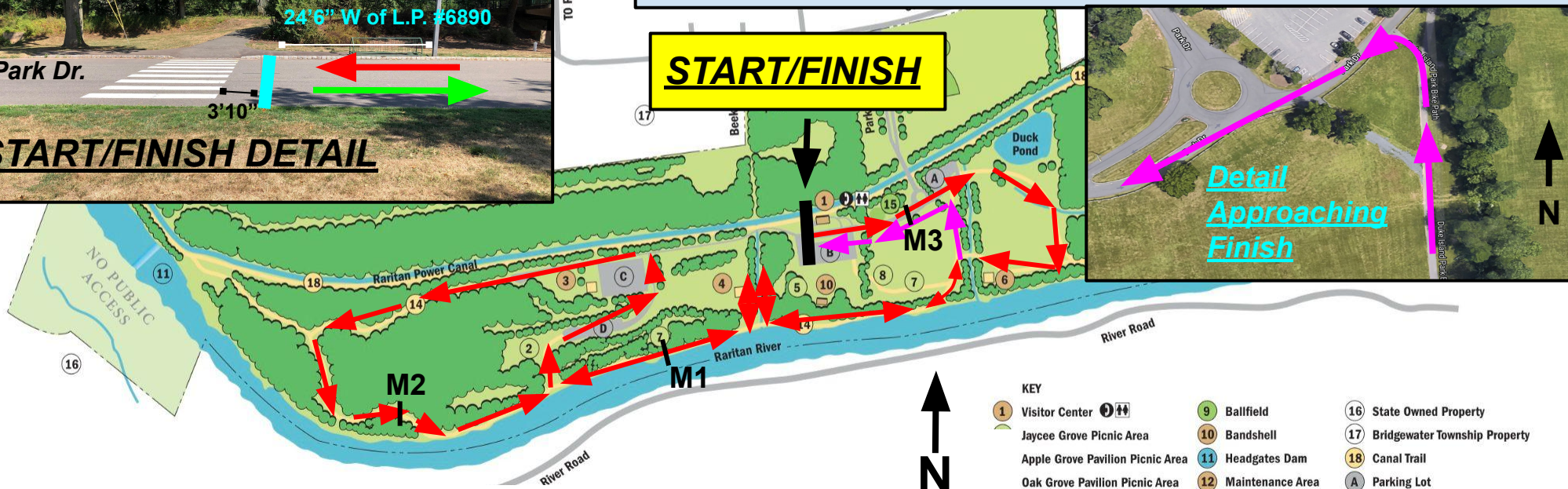

### KEY

- |                                  |                         |                                  |
|----------------------------------|-------------------------|----------------------------------|
| 1 Visitor Center                 | 9 Ballfield             | 16 State Owned Property          |
| Jaycee Grove Picnic Area         | 10 Bandshell            | 17 Bridgewater Township Property |
| Apple Grove Pavilion Picnic Area | 11 Headgates Dam        | 18 Canal Trail                   |
| Oak Grove Pavilion Picnic Area   | 12 Maintenance Area     | A Parking Lot                    |
| Shady Grove Picnic Area          | 13 Parking Area         | B Parking Lot                    |
| 6 Pavilion Grove Picnic Area     | 14 Bikeway              | C Parking Lot                    |
| 7 Unreserved Picnic Tables       | 15 Public Assembly Area | D Parking Lot                    |
| 8 Playground                     |                         |                                  |

Measured by Matthew Slocum / 9 August 2022 / precisioncoursedesign@gmail.com

This course was measured using the full width of the road/path and the shortest possible route.

Please see supplemental pages with detail photos.

Magenta Arrows indicate the final portion of the race as runners approach the finish.



# **DUKE ISLAND PARK 5K-2022**

## **SUPPLEMENTAL DETAIL PAGE 1**

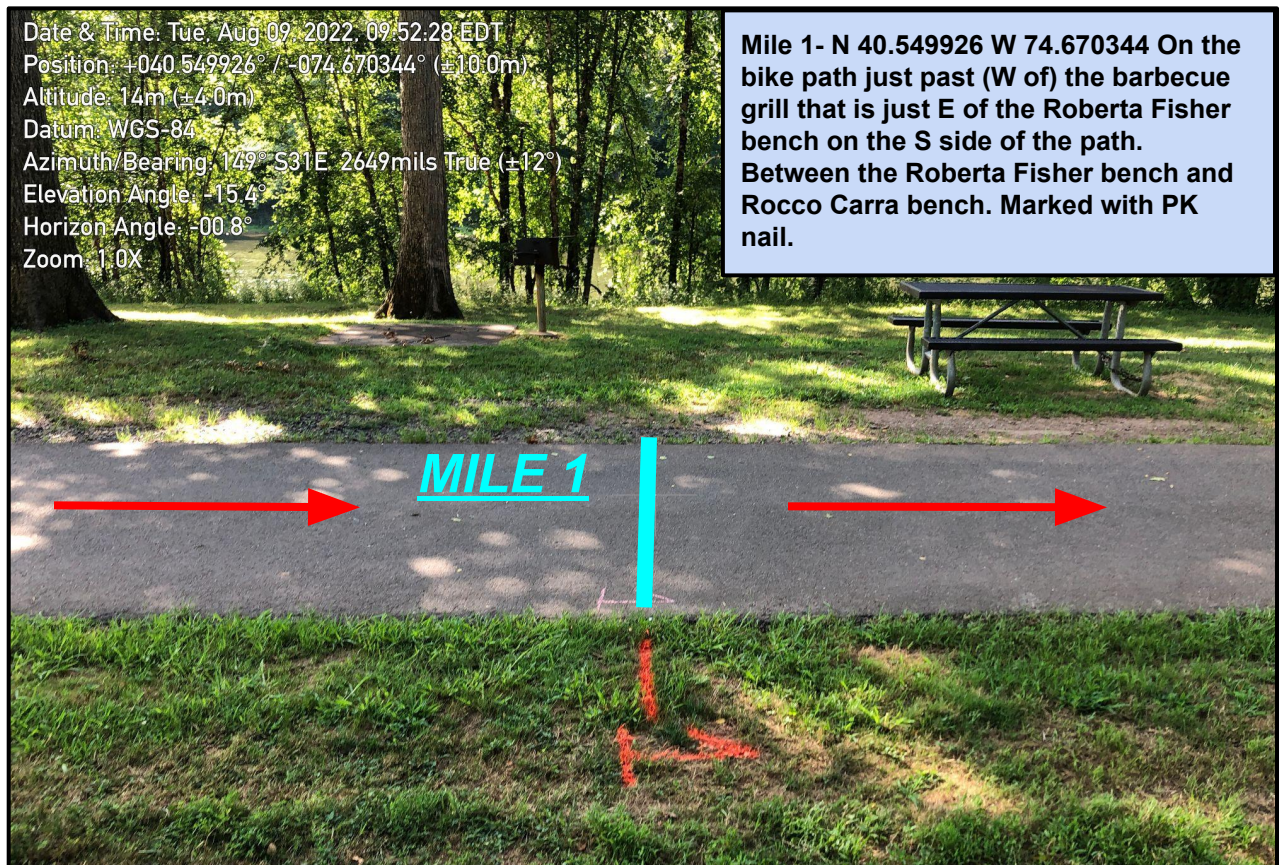



# **DUKE ISLAND PARK 5K-2022**

## **SUPPLEMENTAL DETAIL PAGE 2**

Date & Time: Tue, Aug 09, 2022, 10:11:43 EDT  
Position: +040.548299° / -074.676338° (±5.0m)  
Altitude: 17m (±4.0m)  
Datum: WGS-84  
Azimuth/Bearing: 107° S73E 1902mils True (±12°)  
Elevation Angle: -05.5°  
Horizon Angle: +00.7°  
Zoom: 1.0X



Mile 2- N 40.548299 W 74.676338 Even with the large tree bordering the N side of the path before (W of the) the white fishing line recycling bin.

Date & Time: Tue, Aug 09, 2022, 09:29:00 EDT  
Position: +040.552134° / -074.665199° (±5.0m)  
Altitude: 16m (±3.0m)  
Datum: WGS-84  
Azimuth/Bearing: 172° S08E 3058mils True (±12°)  
Elevation Angle: -03.8°  
Horizon Angle: +00.1°  
Zoom: 1.0X

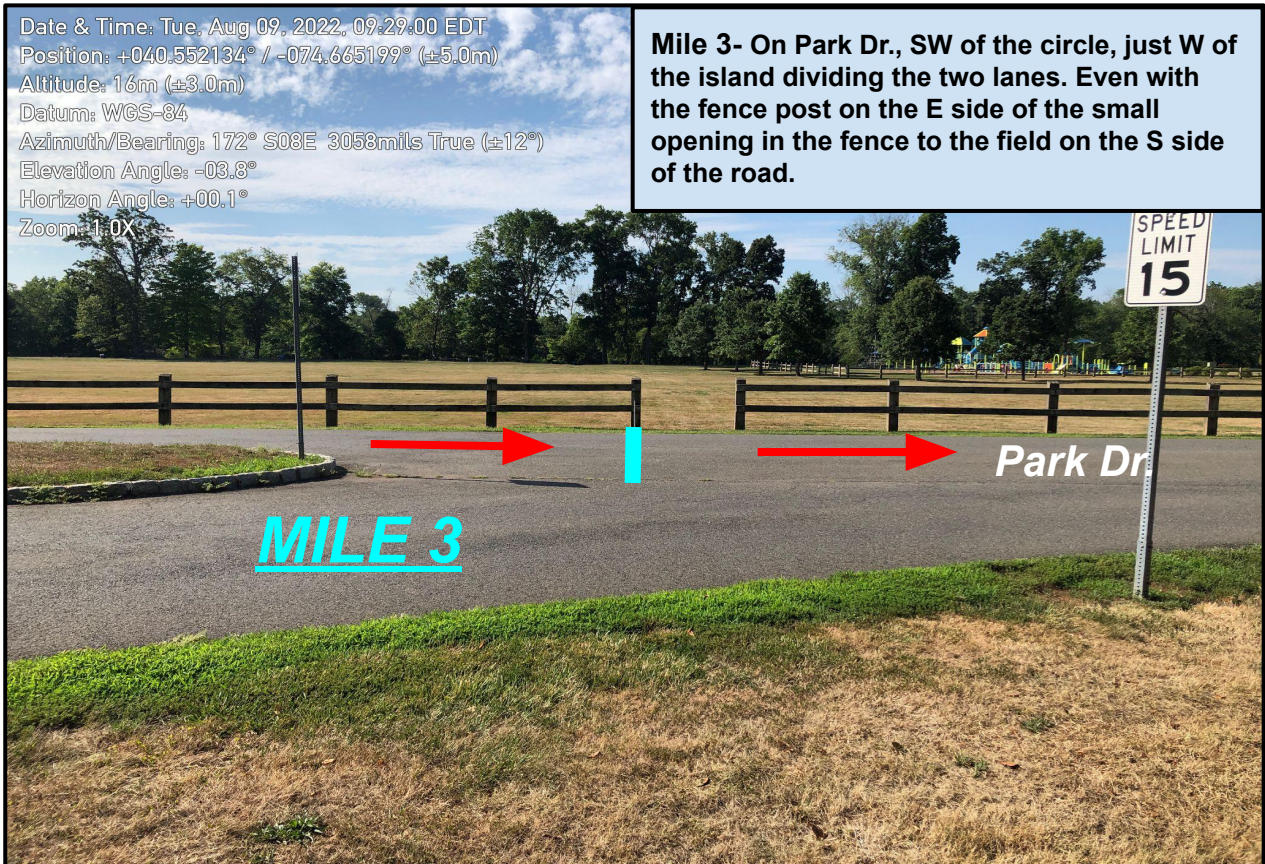

Mile 3- On Park Dr., SW of the circle, just W of the island dividing the two lanes. Even with the fence post on the E side of the small opening in the fence to the field on the S side of the road.