

Reinhartsen Run 5k  
Haw River, NC  
Measured:  
by Brad Smythe  
bdsmythe78@yahoo.com  
on October 11, 2014

USATF Certificate # NC14149DF  
Effective Oct 15, 2014 to Dec 31, 2024

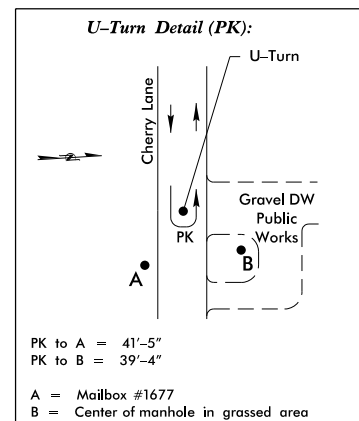
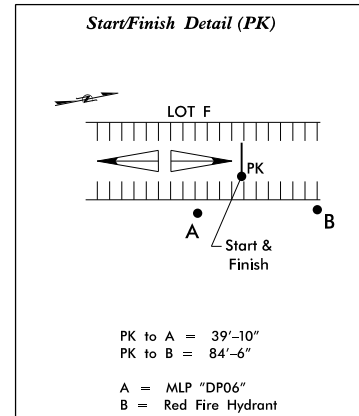
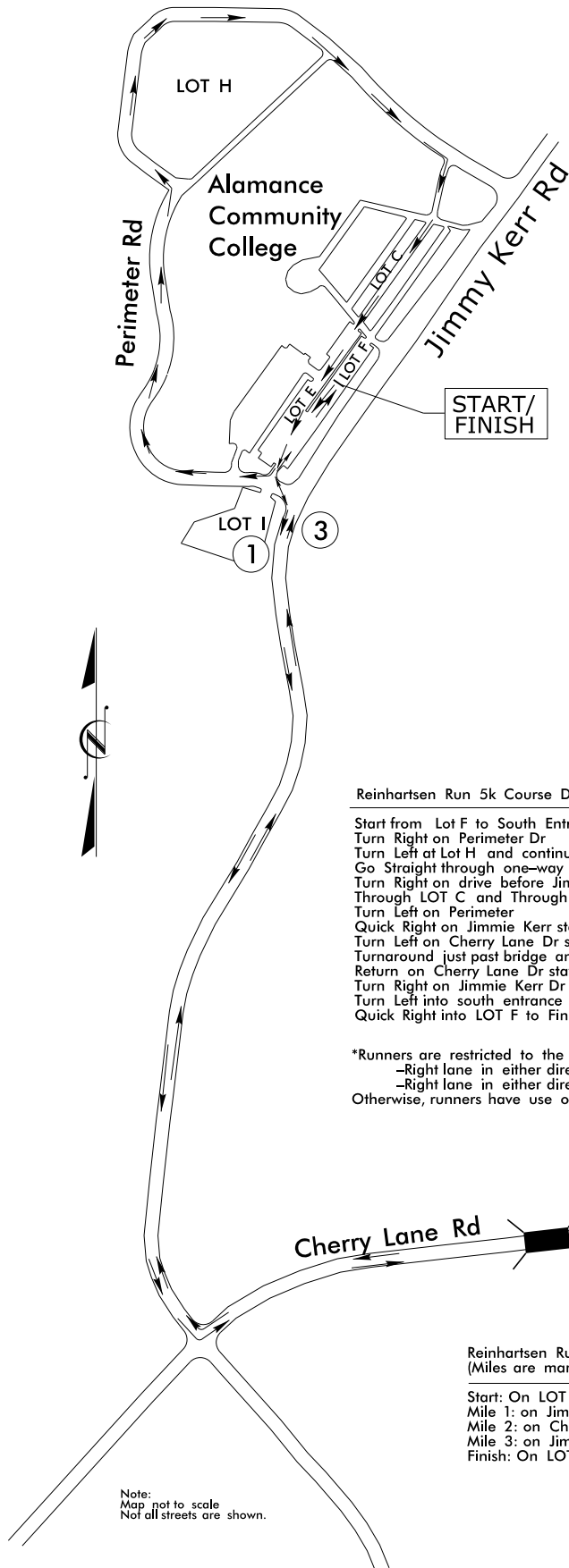

#### Reinhartsen Run 5k Course Directions

Start from Lot F to South Entrance to ACC  
Turn Right on Perimeter Dr  
Turn Left at Lot H and continue on Perimeter Dr  
Go Straight through one-way section on north side of Lot H  
Turn Right on drive before Jimmie Kerr Rd  
Through LOT C and Through LOT E to south entrance of ACC  
Turn Left on Perimeter  
Quick Right on Jimmie Kerr staying in right lane only  
Turn Left on Cherry Lane Dr staying in right lane only  
Turnaround just past bridge and right at gravel access to public works  
Return on Cherry Lane Dr staying in right lane only  
Turn Right on Jimmie Kerr Dr staying in right lane only  
Turn Left into south entrance of ACC  
Quick Right into LOT F to Finish

\*Runners are restricted to the following:  
-Right lane in either direction on Jimmie Kerr Dr  
-Right lane in either direction on Cherry Lane Dr  
Otherwise, runners have use of entire road.\*

#### Reinhartsen Run 5k Split Locations (Miles are marked with Green paint on the runners' right side of the road.)

Start: On LOT F, mid-way of parking aisle, see detail  
Mile 1: on Jimmie Kerr Dr, 7' past WUP "125582442" on right  
Mile 2: on Cherry Lane Dr, on return, 30' past the end of guardrail at public works  
Mile 3: on Jimmie Kerr Dr, 12' before last WUP on right before ACC entrance  
Finish: On LOT F, same as Start

Note:  
Map not to scale  
Not all streets are shown.