

NATIONAL Race to End WOMEN'S CANCER 5K

Washington D.C.

USATF Certificate
DC14020RT
Effective 7/1/2016
to 12/31/2024



Map Not to Scale

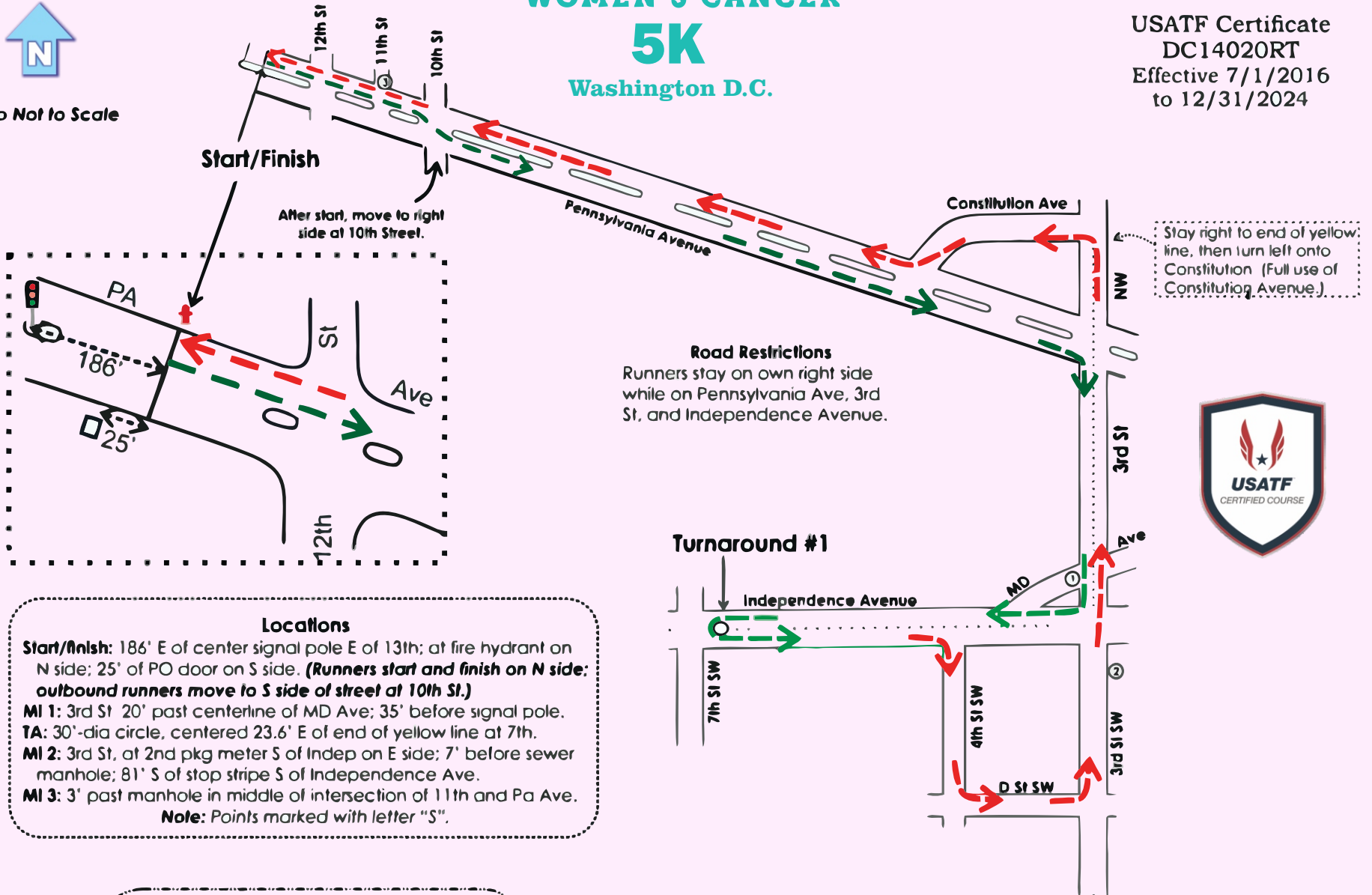

Locations

Start/finish: 186' E of center signal pole E of 13th; at fire hydrant on N side; 25' of PO door on S side. (Runners start and finish on N side; outbound runners move to S side of street at 10th St.)
MI 1: 3rd St 20' past centerline of MD Ave; 35' before signal pole.
TA: 30'-dia circle, centered 23.6' E of end of yellow line at 7th.
MI 2: 3rd St, at 2nd pkg meter S of Indep on E side; 7' before sewer manhole; 81' S of stop stripe S of Independence Ave.
MI 3: 3' past manhole in middle of intersection of 11th and Pa Ave.
Note: Points marked with letter "S".

Key

- Runners' path through Turnaround
- Path after Turnaround to Finish

Road Restrictions
Runners stay on own right side while on Pennsylvania Ave, 3rd St, and Independence Avenue.

Stay right to end of yellow line, then turn left onto Constitution (Full use of Constitution Avenue.)



Elevations: Start/finish 4 m; Highest 7 m; Lowest 2 m
Measured 5 October 2014 by Bob Thurston

Map edited by Lyman Jordan 6-17

RET