



*Road Running Technical Council
USA Track & Field
Measurement Certificate*



Name of the course Houston Turkey Dash Half Distance 21.0975 km
Location (state) TX (city) Houston
Type of course: Road Race
Measuring Methods: Bicycle
Measured By John Chung - 4707 arapahoe pass - Austin, TX 78745 - (512) 524-7271 - john.chung.jc@gmail.com
Race Contact Randi Schooley - 21215 FM 529, Ste. 710, Cypress, TX 77433 - 281-639-1862 - randi@houstonrunningco.cor
Date(s) when course measured: 10/12/2024
Number of measurements of entire course: 2 Course Configuration: partial loop
Elevation (meters above sea level) Start 21.00 Finish 22.00 Lowest 14 Highest 22
Straight line distance between start and finish 103 m Drop -0.05 m/km Separation 0.49 %
Type of surface: Paved 100 % Dirt 0 % Gravel 0 % Grass 0 % Track 0 %
Effective date of certification: October 28, 2024 Certification code: TX24046LAB

Note to Race Director: Use this Certification Code
in all public announcements relating to your race.

Be It Officially Noted That

Based on examination of data provided by the above named measurer, the course described above and in the map attached is hereby certified as reasonably accurate in measurement according to the standards adopted by the Road Running Technical Council. If any changes are made to the course, this certification becomes void, and the course must then be recertified.

Verification of Course --- In the event a National Open Record is set on the course, or at the discretion of USA Track & Field, a verification measurement may be required to be performed by a member of the Road Running Technical Council. If such a remeasurement shows the course to be short, then all pending records will be rejected and the course certification will be cancelled.

This certification expires on December 31 of the year: **2034**

AS NATIONALLY CERTIFIED BY:

Date: October 29, 2024

Logan Burgess - USATF/RRTC Certifier - 614 Stillmeadow Drive, Richardson TX 75081
(214) 803-7800 - loganaburgess@yahoo.com

Houston Turkey Dash Half

21.0975 KM

This course was measured using the Shortest Possible Route (SPR) within restrictions below by John Chung on October 12th, 2024, Houston, Texas.

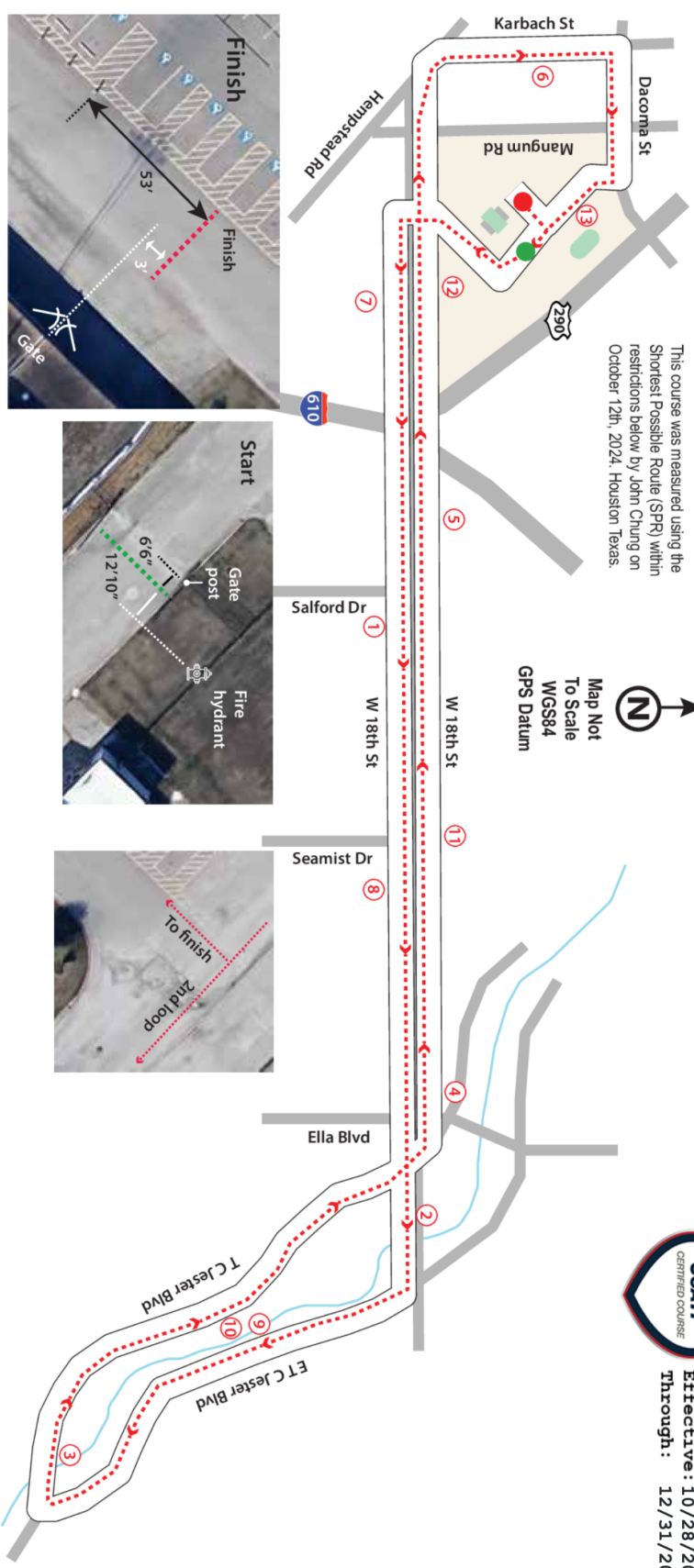

Certified Points:

- Start** - (N 29.804477, W 95.455775) - North of stadium, 6'6" east of gate post, 12'10" west of fire hydrant by the fence line.
 - Finish** - (N 29.804328, W 95.456817) - 53' north of northern most concrete parking pole, 3' north of entrance gate center.
- Northern most gate on the west side of stadium

Mile Markers:

- Mile 1** - (N 29.801448, W 95.444313) - On eastbound W 18th, 3' east of 2514 W 18th's building east edge
- Mile 2** - (N 29.801561, W 95.427620) - On eastbound W 18th, middle of driveway to 1550 and 1770 W 18th
- Mile 3** - (N 29.792368, W 95.420041) - On westbound T C Jester, 36' east of steel railing end at the north curb
- Mile 4** - (N 29.801777, W 95.430731) - On westbound W 18th, event with road expansion joint near 1807 W 18th
- Mile 5** - (N 29.801690, W 95.447435) - On westbound W 18th, 3' east of storm drain edge on the north curb
- Mile 6** - (N 29.804668, W 95.461115) - On Karbach St, even with sidewalk inlay on the east curb
- Mile 7** - (N 29.801508, W 95.453537) - On eastbound W 18th, 72' east of median west edge
- Mile 8** - (N 29.801502, W 95.436852) - On eastbound W 18th, 3' east of telephone box on the south curb
- Mile 9** - (N 29.797800, W 95.423258) - On southbound E T C Jester just before Bewis sl, 45' south of manhole cover at west curb sidewalk
- Mile 10** - (N 29.796848, W 95.424372) - On northbound T C Jester, just after Lindjann Sl, 105' north of median south edge.
- Mile 11** - (N 29.801659, W 95.438161) - On westbound W 18th, even with W 18th signal post on north curb at Seamist
- Mile 12** - (N 29.801559, W 95.454915) - On westbound W 18th, 66' west of median east edge
- Mile 13** - (N 29.805482, W 95.456958) - Even with lamp post by ticket gate house

Runner Restrictions:

- * Runners restricted to lane closest to median on W 18th St, except between Mangum and Karbach
- * Runners restricted to lane closest to bayou on E T C Jester and T C Jester



USATF Certificate
 TX24046LAB
 Effective: 10/28/2024
 Through: 12/31/2034